

INTEGRIS[®] B SERIES HEADWALL SYSTEM ACCESSORIES

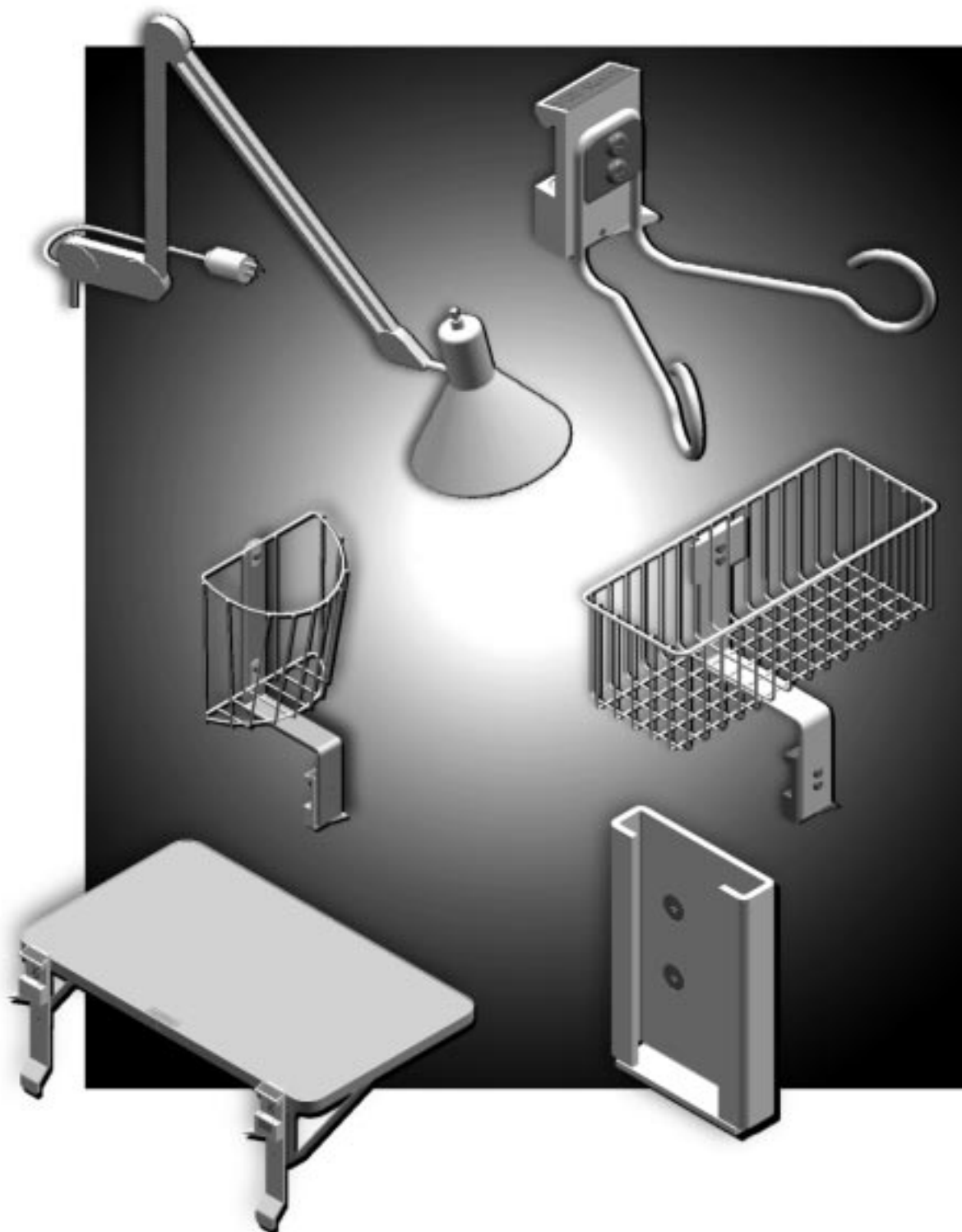

IV Pole Management Solutions



P17000801

Ventilator Mount

16" swing arm holds an adjustable pole 20" long and 1" in diameter. Many ventilators mount directly onto the pole (check manufacturer's ventilator installation instructions). Humidifiers, blenders and heaters may be mounted on the lower portion of the pole. Functional loading up to 50 lbs.



P17000901

Resuscitator Bag Holder - Clip Style

.....



P17001001

IV/Resuscitator Bag Holder - Hook Style

Hook allows for hanging of IV bags and packaged resuscitation bags. Functional loading up to 10 lbs. (5 lbs. per hook).

.....

Model/Position
2001B/Upper	●	●	
2001B/Lower			
2002B/Upper	●	●	
2002B/Lower			
Lite Rail			●

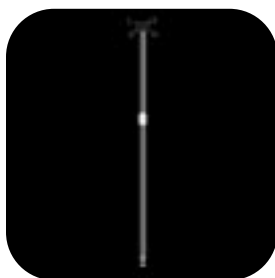

P158

ISS Transfer Pole

Allows transfer of secondary equipment from mobile to fixed positions. Top hooks hold IV bags for gravity drip. Requires ISS Transfer Pole Mount (P17000101). Retracted position 32". Extended position 57¹/₄". Outer pole diameter 1". Functional loading up to 40 lbs.



P17000101

ISS Transfer Pole Mount

Designed to accommodate the ISS Transfer Pole (P158).

.....

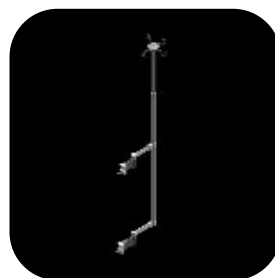

P17000201

IV Pole/Infusion Holder

This assembly provides for attachment of infusion pumps. Retracted position 37¹/₂". Extended position 73¹/₂". Outer pole diameter 1¹/₈". Functional loading up to 55 lbs. (Mounts Included)

.....



P17000301

ISS Single Pole

24", 1/2" diameter Functional loading up to 20 lbs. (Mount Included)

.....

Model/Position
2001B/Upper	●	●		●
2001B/Lower				
2002B/Upper	●	●	●	●
2002B/Lower			●	
Lite Rail				

IV Pole Management Solutions



P17000401

ISS Dual Post
11" Posts
(Mount Included)
Functional loading
up to 30 lbs.



P17000501

ISS Short Post
2 1/4" Post, 3/4" Diameter
Includes Universal
Holder (P17000601).
Functional loading
up to 15 lbs.



P17000601

Universal Holder
Designed to accept
various accessories.



P17000701

Universal Pole Holder
(C-Clamp)
Accepts poles from 3/4"
to 1" in diameter.



Model/Position	P17000401	P17000501	P17000601	P17000701
2001B/Upper	●	●	●	●
2001B/Lower				
2002B/Upper	●	●	●	●
2002B/Lower				
Lite Rail				

Cord Management



P17072001

Cable Organizer



P17073001

Vertical Cord Wrap



P17073101

Horizontal Cord Wrap



Model/Position	P17072001	P17073001	P17073101
2001B/Upper	●	●	●
2001B/Lower			
2002B/Upper	●	●	●
2002B/Lower			
Lite Rail	●		●

Storage Solutions



P17011001

Chart Holder - Stackable

13"W x 2"D x 8½"H
Chart Holder stacks with Basket P17010101 and Shelf P17020101.

⋮



P17011101

Chart Holder

13"W x 10"H

⋮



P17012001

Sharps Container Mount

Fits most containers.

⋮



P17013001

Glove Box Holder

Holds 3 boxes, most sizes.

⋮

Model/Position	P17011001	P17011101	P17012001	P17013001
2001B/Upper	●	●	●	●
2001B/Lower				
2002B/Upper	●	●	●	●
2002B/Lower				
Lite Rail				



P17014001

Nursemate Door/Drawer Unit

Laminate selection required.
Inside drawer:
17"W x 13⅙"D x 3¼"H
Overall:
20½"W x 16¼"D x 23¾"H
Overall weight: 57 lbs.
Functional loading:
• 10 lbs. per drawer
• 20 lbs. per top shelf

⋮



P17014101

Nursemate Three Drawer Unit

Laminate selection required.
Inside drawer:
17"W x 13⅙"D x 3¼"H
Overall:
20½"W x 16¼"D x 23¾"H
Overall weight: 57 lbs.
Functional loading:
• 10 lbs. per drawer
• 20 lbs. per top shelf

⋮



P17014201

Nursemate One Drawer Unit

Laminate selection required.
Inside drawer:
17"W x 13⅙"D x 3¼"H
Overall:
20½"W x 16¼"D x 6½"H
Overall weight: 20 lbs.
Functional loading:
• 10 lbs. per drawer
• 20 lbs. per top shelf

⋮

Model/Position	P17014001	P17014101	P17014201
2001B/Upper			●
2001B/Lower			
2002B/Upper	●**	●**	
2002B/Lower	●**	●**	
Lite Rail			

* P17014001 and P17014101 require both rails for mounting.

Baskets

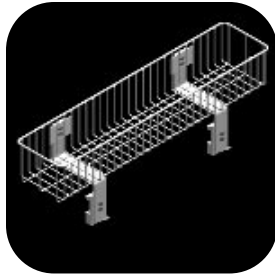

P17010101

Basket - Stackable
 21³/₈"W x 2⁷/₈"D x 4⁵/₁₆"H
 Functional loading to 5 lbs. Basket stacks to Chart Holder P17011001 and Shelf P17020101. (Basket mounts up and over rail.)



P17010201

Basket
 18"W x 9¹/₂"D x 4"H
 Functional loading to 10 lbs. Includes three dividers. (Basket mounts up and over rail.)



P17010202

Basket
 18"W x 9¹/₂"D x 4"H
 Functional loading to 10 lbs. Includes three dividers. (Basket mounts in front of rail.)



P17010301

Basket
 6¹/₂"W x 4"D x 5"H
 Functional loading to 5 lbs. (Basket mounts up and over rail.)

Model/Position	⋮	⋮	⋮	⋮
2001B/Upper	●	●	●	●
2001B/Lower			●*	
2002B/Upper	●	●	●	●
2002B/Lower			●	
Lite Rail				



P17010302

Basket
 6¹/₂"W x 4"D x 5"H
 Functional loading to 5 lbs. (Basket mounts in front of rail.)



P17010401

Basket
 11"W x 4"D x 4"H
 Functional loading to 5 lbs. (Basket mounts up and over rail.)



P17010402

Basket
 11"W x 4"D x 4"H
 Functional loading to 5 lbs. (Basket mounts in front of rail.)



P17010501

Basket - Pivoting
 9⁹/₁₆"W x 9⁹/₁₆"D x 4"H
 Functional loading to 5 lbs. Designed to pivot. Inner liner is provided to contain supplies.

Model/Position	⋮	⋮	⋮	⋮
2001B/Upper	●	●	●	●
2001B/Lower	●*		●*	●*
2002B/Upper	●	●	●	●
2002B/Lower	●		●	●
Lite Rail				

* Requires purchase and installation of Lower Accessory Rail - 2001B.

Shelves



P17020301

Hinged Mayo Tray

Stainless steel tray
13⁵/₈"W x 9³/₄"D
Tray folds down easily
when not in use.
Functional loading up
to 15 lbs.

⋮

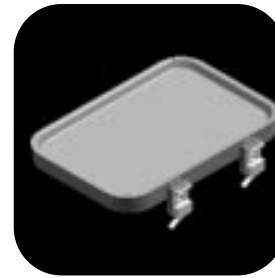

P17020401

Hinged Mayo Tray

Stainless steel tray
17¹/₈"W x 11⁵/₈"D
Tray folds down easily
when not in use.
Functional loading up
to 15 lbs.

⋮

Model/Position	P17020301	P17020401
2001B/Upper	●	●
2001B/Lower		
2002B/Upper	●	●
2002B/Lower		
Lite Rail		



P17020101

Utility Shelf

Laminate: Wilsonart
1572-60 Antique White
20³/₈"W x 12¹/₈"D
Functional loading up to
50 lbs. Stacks with
Basket P17010101 and
Chart Holder P17011001.

⋮



P17020201

Charting Shelf

Laminate: Wilsonart
1572-60 Antique White
20³/₈"W x 12¹/₈"D
Functional loading up
to 50 lbs.

⋮



P17020501

Utility Shelf

Laminate: Wilsonart
1572-60 Antique White
12"W x 10"D
Functional loading up
to 15 lbs.

⋮

Model/Position	P17020101	P17020201	P17020501
2001B/Upper	●	●	
2001B/Lower			
2002B/Upper	●	●	
2002B/Lower			
Lite Rail			●

Lights

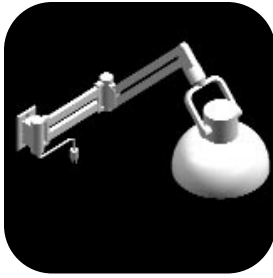

P965-01

Exam Plus Light

Extends 44"
Requires power outlet and Exam Light Mount (P17030201).

⋮



P17030201

Exam Light Mount

Only for Exam Plus Light.

⋮



P17030501

Utility Light

4 1/2" arm
Includes mount.

⋮



P17030601

Mount for Burton CoolSpot, CoolSpot II or Outpatient II Light

(Light not available through Hill-Rom.)

⋮

Model/Position

2001B/Upper			●	
2001B/Lower				
2002B/Upper			●	
2002B/Lower				
Lite Rail	●	●	●	●



P963C01

Arm Lamp with Incandescent Bulb

Arm extends to 46"
Requires power outlet and Universal Light Mount (P17030701).

⋮



P963C02

Arm Lamp with Fluorescent and Incandescent Bulbs

Arm extends to 46"
Requires power outlet and Universal Light Mount (P17030701).

⋮



P17030701

Universal Light Mount

(Not for use with Burton Lights) Accepts standard post-mount lights 9/16" hole diameter.

⋮

Model/Position

2001B/Upper	●		●	●
2001B/Lower				
2002B/Upper	●		●	●
2002B/Lower				
Lite Rail				

Syngmanometers and Other Diagnostic Equipment Mounting Solutions

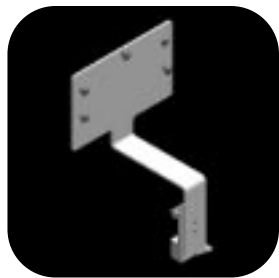

P17040101

Integrated Diagnostic System - 767

For Welch Allyn Model 767 only.
9⁷/₁₆"W x 2¹/₂"D x 7"H

⋮



P17040201

Integrated Diagnostic System - 747

For Welch Allyn Model 747 only.
2³/₄"W x 4¹/₄"H

⋮

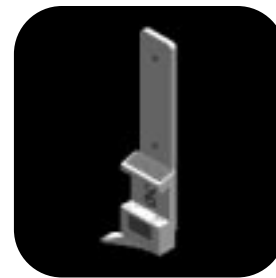

P17040401

Speculum Mount

For Welch Allyn Dispensers only.

⋮

Model/Position	P17040101	P17040201	P17040401
2001B/Upper	●	●	●
2001B/Lower			
2002B/Upper	●	●	●
2002B/Lower			
Lite Rail			



P17041001

Tycos Model 5091-38

Includes P17041101 mount.

⋮



P17041101

Tycos Model 5091-38 Mount

⋮



P17041201

Tycos Model 7670-01

Includes P17041301 mount.

⋮

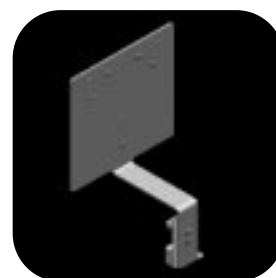

P17041301

Tycos Model 7670-01 and DIATEK

6000/9000 Thermometer Mount

⋮

Model/Position	P17041001	P17041101	P17041201	P17041301
2001B/Upper	●	●	●	●
2001B/Lower				
2002B/Upper	●	●	●	●
2002B/Lower				
Lite Rail				

Sphygmomanometers and Other Diagnostic Equipment Mounting Solutions



P17041401

Baum Mercury Sphygmomanometer
Includes P17041501 mount.



P17041501

Baum Mercury Sphygmomanometer Mount



P17041601

Cuff Basket
Includes P17041701 mount.



Model/Position

2001B/Upper	●		●		●
2001B/Lower					
2002B/Upper	●		●		●
2002B/Lower					
Lite Rail					



P17041701

Cuff Basket Mount



P17041801

Utility Hook



P17044001

Stat Clock Timer
Designed to provide easy-to-read numbers and accurate timekeeping. It provides the time, date and elapsed time mode for code blue situations. Includes mount.



Model/Position

2001B/Upper	●		●		●
2001B/Lower					
2002B/Upper	●		●		●
2002B/Lower					
Lite Rail					●

Syngmanometers and Other Diagnostic Equipment Mounting Solutions



P17043001

Conchatherm Humidifier and Heater
Slide Adapter only.

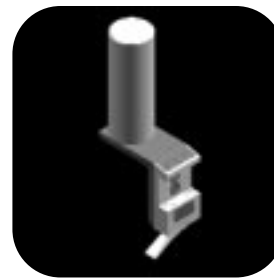

P17043101

Puritan-Bennett Humidifier Holder
For Cascade humidifier.
Post is 4" high, 1 1/2" diameter.

Model/Position	P17043001	P17043101
2001B/Upper	●	●
2001B/Lower		
2002B/Upper	●	●
2002B/Lower		
Lite Rail		

Mounting Adapters



P17074001

Standard Cam Adapter
Utilizes one locking lever.



P17074101

Ball-Action Adapter
Must be secured in place with a 7/32" hex wrench.



P17074201

Double Cam Adapter
For mounting heavier equipment - utilizes two locking levers.

Model/Position	P17074001	P17074101	P17074201
2001B/Upper	●	●	●
2001B/Lower	●*	●*	●*
2002B/Upper	●	●	●
2002B/Lower	●	●	●
Lite Rail	●	●	●

* Requires purchase and installation of Lower Accessory Rail - 2001B.

Monitor and TV Mounting Solutions

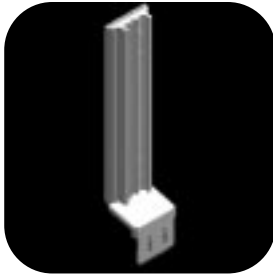

P17050101

Monitor Channel

For placement of monitoring equipment. Information about type of monitor is required. Use in combination with P962-00 or P997A03.



P962-00

Tilt/Swivel Arm

Allows for placement adjustments of monitoring equipment. Information about the monitor is required. Use in combination with P17050101.



P997A03

Monitor Arm

Provides flexible patient monitor positioning, 220° articulation (side-to-side) and 12" of vertical travel. Use in combination with P17050101.



P997-10

Monitor Mount Kit

(Mounting plate and grab rail.) Use in combination with P997A03.

Model/Position	P17050101	P962-00	P997A03	P997-10
2001B/Upper	●**			
2001B/Lower				
2002B/Upper	●**			
2002B/Lower				
Lite Rail	●**			

2001B/Upper	●**			
2001B/Lower				
2002B/Upper	●**			
2002B/Lower				
Lite Rail	●**			



P17050401

Satellite Rack Mount
(Hewlett-Packard only)

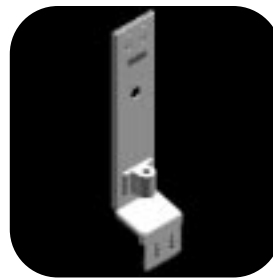

P17051001

TV Arm Mount
Allows positioning of TV only. (RCA/Phillips 5/8" diameter)

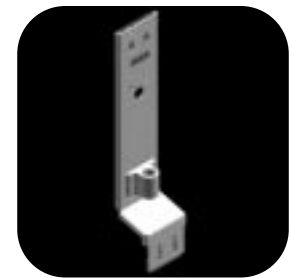

P17051201

TV Arm Mount
Allows positioning of TV. Bunting only, 1/2" diameter.



Model/Position	P17050401	P17051001	P17051201
2001B/Upper	●	●**	●**
2001B/Lower			
2002B/Upper	●	●**	●**
2002B/Lower			
Lite Rail		●**	●**

2001B/Upper	●	●**	●**
2001B/Lower			
2002B/Upper	●	●**	●**
2002B/Lower			
Lite Rail		●**	●**

** Accessory must be attached to both a Headwall and a Lite Rail.

Bed Bumpers

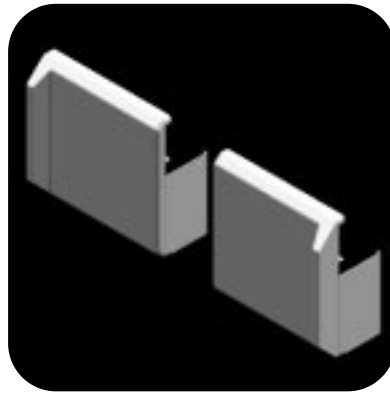

P17060101

Bed Bumpers

Dimensions 11 1/4"W x 1 1/4"H
 Extension from wall 7/8" - 1 5/8"

Model/Position	
2001B/Upper	
2001B/Lower	
2002B/Upper	
2002B/Lower	●
Lite Rail	

Slides/Blenders and Clips



P17071001

Dual Clip Assembly

⋮



P17070101

Standard Slide Adapter
 1 3/16" inner width

⋮

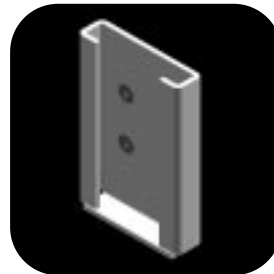

P17070201

Bird Blender Slide

Used to mount oxygen blenders, bottle holders, suction canisters and other slide-mounted devices. Adapter for Bird Blenders.

⋮



P17070301

Bird Blender Slide Adapter

Adapter used to mount oxygen blenders, bottle holders, suction canisters and other slide mounted devices. Adapter for Bird Blender (above rail).

⋮

Model/Position				
2001B/Upper		●		●
2001B/Lower		●*		
2002B/Upper		●	●	●
2002B/Lower		●		
Lite Rail	●			

* Requires purchase and installation of Lower Accessory Rail - 2001B.

Accessory Rails

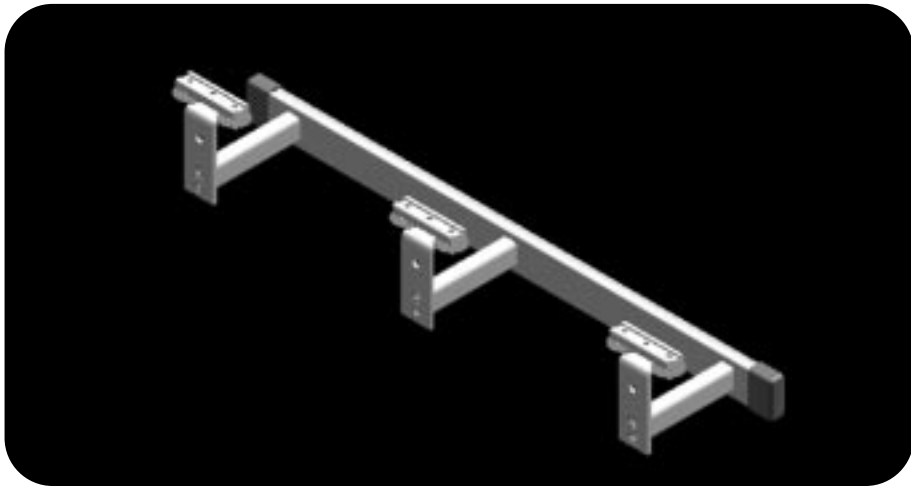

Lower Accessory Rail for 2001B Headwall

Add horizontal accessory bar for extra level of equipment management. Accessories on Product/Position matrix that are compatible with 2001B Lower Rail require purchase and installation of this product.

Available lengths:

- | | |
|--------------------------------|--------------------------------|
| Accessory Rail - 9" P17080001 | Accessory Rail - 36" P17080010 |
| Accessory Rail - 12" P17080002 | Accessory Rail - 39" P17080011 |
| Accessory Rail - 15" P17080003 | Accessory Rail - 42" P17080012 |
| Accessory Rail - 18" P17080004 | Accessory Rail - 45" P17080013 |
| Accessory Rail - 21" P17080005 | Accessory Rail - 48" P17080014 |
| Accessory Rail - 24" P17080006 | Accessory Rail - 51" P17080015 |
| Accessory Rail - 27" P17080007 | Accessory Rail - 54" P17080016 |
| Accessory Rail - 30" P17080008 | Accessory Rail - 57" P17080017 |
| Accessory Rail - 33" P17080009 | |

Model/Position	
2001B/Upper	
2001B/Lower	
2002B/Upper	
2002B/Lower	
Lite Rail	

DIRECT CUSTOMER SERVICE HOTLINE:
USA 800-445-3730
CANADA 800-267-2337

DIRECT TECHNICAL SUPPORT HOTLINE:
USA 800-445-3720

*Complete technical and architectural
design data is available upon request from
your Architectural Products Specialist
or visit us at www.hill-rom.com.*

Hill-Rom[®]

A HILLENBRAND INDUSTRY

Batesville, IN 47006 USA • FAX 812-934-1697
International • 812-934-8173 • FAX 812-934-7191
www.hill-rom.com
CTG226 RA 7.01



Hill-Rom reserves the right to make changes without notice in design, specifications and models. The only warranty Hill-Rom makes is the express written warranty extended on the sale or rental of its products.
© 2001 Hill-Rom Company, Inc.
ALL RIGHTS RESERVED.